

These instructions work with Contemporary Series models: 1400, 2400, 3800, 5200 Vault 3100, Loft 1400 Built In and 2400 Built In

Note: Grill sits on top of hinge plates.
Model shown is 2400

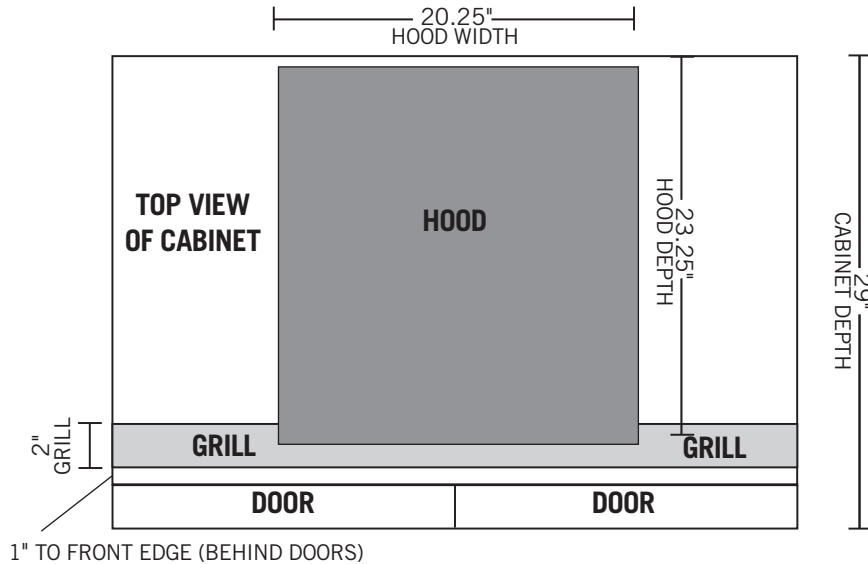

Intake hood without grill



Intake hood with grill

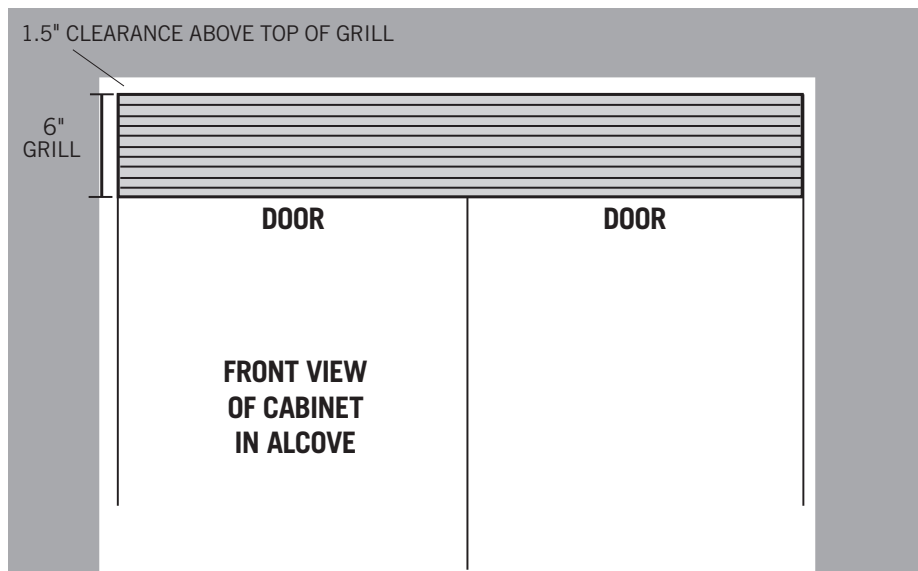

UNIT NEEDS 7.5" CLEARANCE FOR INTAKE HOOD TO BE REMOVED TO ACCESS FILTER

NOTE: IF THE CABINET IS INSTALLED WITH THE FRONT OF THE DOORS FLUSH TO THE WALL, THERE NEEDS TO BE SIDE CLEARANCE OF 1.75" ON EACH SIDE OF THE CABINET FOR DOORS TO OPEN.

